

Global Motion Technology Inc (www.motiontek.ca)

Ball screw Nut catalog no.CN-BS01

All measurement are in metric mm, each inch = 25.4 mm

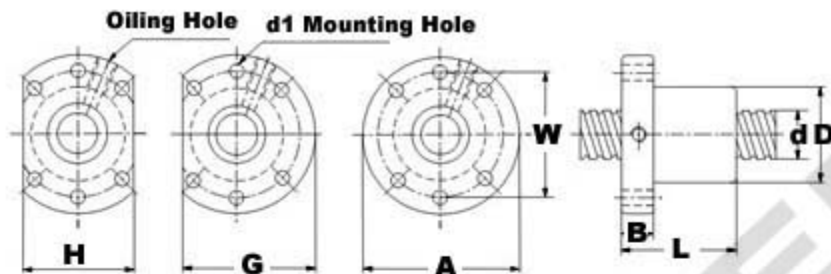

MODEL NO.	MAIN DIMENSIONS					MOUNTING DIMENSION							BASIC LOAD RATING		RIGIDITY (kgf/um)	
	SCREW DIAMETER	THREAD DISTANCE	BALL DIAMETER	NUT OUTER DIAMETER	BALL CIRCULATION NUMBER	Q	A	G	H	L	B	W	d1	C(kgf)		Co(kgf)
	d	s	Da	D	n											K
BS16	16	5	3.175	28	4	M6	48	44	40	50	10	38	5.5	780	1790	20
BS20	20	5	3.175	36	4	M6	58	51	44	51	10	47	6.6	1130	2380	25
BS25	25	5	3.175	40	4	M8	62	55	48	51	10	51	6.6	1280	3110	35
BS325	32	5	3.175	50	4	M8	80	71	62	52	12	65	9	1450	4150	40
BS3210		10	6.35	50	4	M8	80	71	62	90	12	65	9	3390	7170	40
BS405	40	5	3.175	63	4	M8	93	81.5	70	55	14	78	9	1610	5350	49
BS4010		10	6.35	63	4	M8	93	81.5	70	93	14	78	9	3910	9520	50
BS50	50	10	6.35	75	4	M8	110	97.5	85	93	16	93	11	4450	12500	65
BS63	63	10	6.35	90	4	M8	125	100	95	98	18	108	11	5070	16600	80
BS80	80	10	6.35	105	4	M8	145	127.5	110	98	20	125	13.5	5620	21300	90